

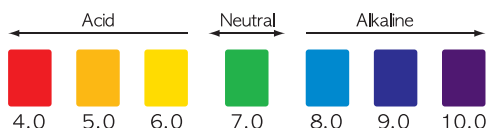

<http://www.tyentusa.com>

- The user should be responsible for failure or improper selection or improper use of the products such as use in any manner for which the product was not originally intended.
- This product is subject to changes that enhance its performance without prior notification.
- Tyent does not assume any responsibility for users' negligent or improper use of the product.

pH Chart



How to Measure: Place 10-15 mL of test water in a container and add 2-3 drops of reagent. Then mix well and check the color of the water with the pH chart above.
(The color depends on water quality and reagent.)

- If the supply cord is damaged, it must be replaced by the manufacturer, its service agent or similarly qualified persons in order to avoid a hazard.
- This appliance is not intended for use by persons (including children) with reduced physical sensory or mental capabilities or lack of experience and knowledge, unless they have been given supervision or instruction concerning use of the appliance by a person responsible for their safety.
- Children should be supervised to ensure that they do not play with the appliance.

MADE IN KOREA



TYENT
WATER IONIZER



User Manual

- This product is intended for domestic use only.
- Keep this user manual handy for easy reference.
- Carefully read this User Manual, particularly "all safety warnings."

To Our Valued Customers

Thank you for purchasing the **Tyent Ace YT20-TL series** Water Ionizer.
Please read all safety warnings and this User Manual carefully before using this product to ensure proper product usage. (Keep the manual handy for easy reference.)

- We are not responsible for any accidents and/or malfunctions due to the improper use of this machine
- Please keep the manual and warranty card in a safe place, so that it's easily accessible when you need it
- Please refer to this manual often when you have questions when using or when troubleshooting this unit

Intended Use

This device creates **functional alkaline ionized water**. It changes the properties of regular tap water through the use of electrolysis. Following are the changes normal tap water undergoes via this process:

- An increase or decrease in pH level
- Creation of negatively charged hydrogen ions (antioxidants)
- Purification through filtration

Table of Contents

To Our Valued Customers	2
Table of Contents	3
Before Usage	4
Safety Precautions and Warnings	5
Product Features	10
Package Contents	14
Unit Overview	15
How to Install the Unit	16
Water Hose Installation	18
Customer Serviceable Parts	20
How to Change the Filters	21
How to Reset the Filters	22
Operation of the Touch Screen	23
When Using the Touch Screen	27
pH Level Adjustment	30
System Setup Method	31
Selecting Voice On/Off	36
Cleaning Function	37
ECO Mode	38
TURBO Function	39
Usage Recommendations	40
Temperature Sensor	42
Unit Specifications	43
Troubleshooting	44
Product Warranty	47

Before Usage

Safety precautions are provided for the safe and proper use of this unit and can prevent danger, bodily harm and/or possible damage due to misuse. Please make sure you are familiar with all the safety precautions and warnings associated with this unit.



DANGER (Red Warning Sign) indicates an imminent hazard that could result in serious injury or death. If you see this sign, stop using this unit immediately.



WARNING (Orange Warning Sign) indicates a potential hazard that could result in significant bodily harm or damage to the unit. If you see this sign, stop the use of this unit.



ATTENTION (Yellow Warning Sign) indicates a potential hazard that could result in minor bodily harm or damage to the unit.

1. Do not drink functional water with medication. When taking medication, use "clean H₂O" filtered water thirty minutes prior to taking medication as well as with medication. You may resume drinking functional water thirty minutes after taking medication.
2. Always consult your primary care physician before drinking functional water. Only drink a small amount near a neutral pH level for the first week. This will give the body time to adjust to functional water during the detoxification period. See Welcome Guide for full details on getting started.
3. If you notice any negative effects from drinking functional water, stop drinking the functional water immediately and consult your primary care physician about changes in your body's pH level.
4. If you are currently under the care of a primary care physician for an existing condition, consult your primary care physician about how changes in pH and other characteristics of functional water could affect your medical condition.
5. If you suffer from gastric acidity, kidney failure or potassium excretion, you should not drink functional water.
6. Verify the pH levels of the functional water dispensed from this unit on a monthly basis to ensure proper function. This can be done with the supplied reagent drops and a pH color chart.
7. When switching from one pH to another, it is good practice to let the water run for several seconds before using.
8. It is common to drink half your body weight in ounces. For example, if you weigh 180 pounds, it may be wise to drink 90 ounces every day of water per day. This especially applies after you have given your body some time to adjust to the new pH level.
9. The recommended drinking level for functional water is 9.5 pH (+/-0.3). It is not recommended to drink functional water above a pH of 10.
10. If you wish to store functional water, use a glass or other nonleaching material with an airtight lid and store it in the refrigerator. Functional water will begin to weaken immediately and will lose most of its benefits after 3 days.
11. Never run hot water through this unit.
12. Never drink acidic water.

Safety Precautions and Warnings

Regarding the Power Supply



Always use a grounded power outlet.

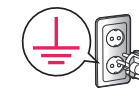

Do not use if the power cord is damaged or in a loose power outlet.



Do not pull the power cord. Never touch the power cord or the power outlet with wet hands.



Do not forcibly bend, squeeze, damage or crush the power cord under heavy objects.



Unplug the power cord during general maintenance, repair and inspection and while replacing parts.



Do not use power surge protectors with this unit. Use unit with its own dedicated power source.





Only use the unit with the correct voltage. All units sold within North America are made to be plugged into 115 Volt outlets only. Do not plug unit into an outlet outside of North America. If you plan to leave the country with your unit, please consult with your service provider first.

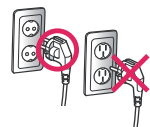

To reduce the risk of electric shock, do not remove the cover; there are no user-serviceable parts inside. Refer servicing to qualified service personnel. Removing the cover will void the warranty.



Installation



Do not place this unit near heat sources.



Do not place this unit on an uneven surface. Do not drop or use excessive force on this unit.



Do not connect the water line to a hot water supply.

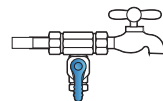

Do not use unfit raw water in accordance with the standards of the water service act.



Do not use in areas of high humidity and/or high temperature.



Place this product near a sink and always allow the water to drain into the sink.

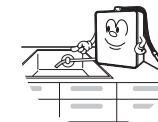

Place the acidic water outlet hose within the height of the unit. Make sure the end of the hose is placed less than 8 inches (20 cm) from the bottom of the unit.

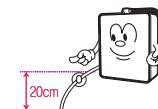

If the unit is not used for a few days, let the water run for 1-2 minutes before drinking functional water.



Usage



If the unit won't be used for a long time, shut off the valve and unplug the power cord.

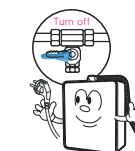

If you hear strange noises, smell a burning odor or see smoke, unplug the power cord immediately and call qualified personnel for service.



Replace filters every 6 months to optimize the purification performance of this unit even if the replacement indicator light isn't turned on.





Do not place any objects on top of this unit no matter how small they are.



If water leaks out of the unit (other than the hoses) or if the unit is standing in a puddle of water, shut off the water supply, unplug the power cord and contact qualified service personnel for service.

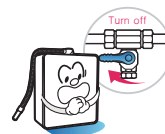

Do not poke or scratch the touch pad or LCD display with sharp objects.



In areas of hard water (calcium scaling present on faucets), notify your service provider and install a cell safe antiscaling prefilter to protect the ionizer from scaling.



Do not use alkaline or acidic water in fish bowls or aquariums. The sudden change in pH could be harmful or fatal to some marine life.



It is beneficial for the maintenance of the machine to run a strong acidic level for 5-minute cycles twice weekly. This will help to maintain a clean chamber.



It is normal for condensation to be present on the unit during humid summer months. If condensation persists despite weather conditions, unplug the power cord and refer servicing to qualified service personnel.



Cleaning



Do not store the unit near chemicals, food, metals or medication



benzene or thinner..... Danger



Do not spray water on the main unit. Do not clean the unit with benzene or other chemicals, which may leak into the unit. If using a damp cloth, be very careful not to get electronic display wet.



Storage



Remove the filters and turn them upside down to remove excess water before storing.



If the original packaging is not available, cover the unit in plastic to avoid scratching the surface.



Store the unit in its original packaging in a cool, dry place when not in use.



Carefully remove this unit from its packaging. Keep the original packaging for future storage and unit transportation.

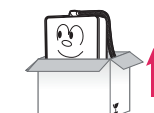

Product Features

FULL TOUCH LCD – TRANSFORMATION AT YOUR FINGERTIPS



The Industry's First Full Touch Screen Panel

The full touch screen panel system automatically activates the unit's operations through a simple touch to the desired icon displayed on the screen.



Touch LCD Screen with a Clear Picture Tone

A 262,000 color touch and LCD display provides a range of information in true vivid colors for user convenience.



GUI [Graphical User Interface]

A graphical user interface is designed specifically for ease of use and operation. Communication between the user and ionizer has never been this simple!

A MORE POWERFUL SYSTEM ENGINE!



Upgraded Power Turbo System

Turbo upgrades to the SMPS power supply system produce both the acid turbo water and strong alkaline water you need!

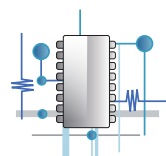

Powered by SMPS Plus® Power Supply System

SMPS Plus® Power Supply System provides the maximum output needed to produce highly stable electric power required for each phase of electrolysis. SMPS Plus is engineered specifically for adjustability and variable voltage, which allows the unit to be customized for your unique source water.



Electrodes with Solid/Mesh Hybrid Technology

These platinum-coated titanium plates are made with highly stable, durable Solid/Mesh Hybrid Technology that enhances the instantaneous electrolysis effect.

IMPORTANT CONSIDERATIONS FOR THE USER



Excellent Sound Quality with Guided Support

Functions under operation can be further identified by the top-quality voice guided system.



Multiple Languages Supported

Diversified language guide support is available by selecting 1 of 4 languages featured from around the world.

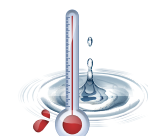

Temperature Sensor Function for Safe Operation

If the temperature of the source water exceeds 95°F (35°C), then water will stop flowing and a warning message will appear on the screen.



Automatic Water Discharge Interruption Function

In order to prevent the overflow of water due to user negligence, the water discharge is automatically stopped after 15 minutes of use.
(*Turbo: 5 minutes)

Product Features



Automatic Electrolysis Tank Cleaning Function

The interior of the electrolysis tank is automatically cleaned on a regular basis, ensuring stable electrolysis operating conditions.



Automatic Memory Function

The last function used by the user is automatically memorized and displayed on the standby screen for fast and convenient operation.



Water Discharge Nozzle with Directional Control

The water discharge direction may be adjusted to many diverse angles based on user preference.

CARE FOR THE ENVIRONMENT



Earth-Friendly Technology When in ECO Mode

When setting the eco-mode, the LCD backlight will be turned off automatically during periods of nonuse and the Time function is displayed.

FRESH, PURIFIED WATER IS A MUST ALONG WITH HEALTHY MINERALS!



Water Purification through a Clean Process

Perfect, seamless elimination of foreign substances including residual chlorine, organic & inorganic compounds through the filtering process using functional UF and π Ceramic materials, enhancing the alkali water producing condition.

SELF-MAINTENANCE MADE EASY – FROM INSTALLATION TO AFTER SERVICE



Filter Usage Indication and Replacement Time Guide

The level of filter usage can be identified through the LCD screen on a real-time basis. The recommended replacement time is automatically displayed on the screen with a voice guide.



Super Simple Filter Replacement System

A simple filter replacement system along with a one- filter usage initialization setting system makes filter management easy for anyone.



Convenience of Operating Condition Setting System

The unit features an easy setting system, allowing users to conveniently set or cancel the desired settings through the LCD screen."



pH Control Function

Respective alkali, acid and turbo phases can be easily controlled by the user.



Self-Diagnosis Function

When the condition of the source water is not suitable, the water discharge is automatically suspended, displaying a warning sign on the screen.

Package Contents

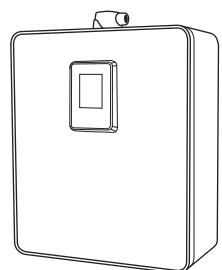

1 Water Ionizer

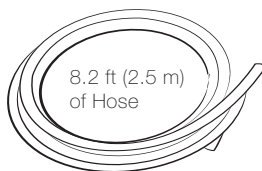

8.2 ft (2.5 m)
of Hose

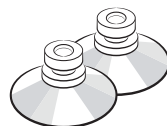

2 Tube Suction Cups



1 Water Outlet Tube

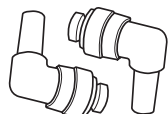

2 Stem Elbows

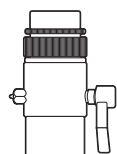

1 Faucet Diverter

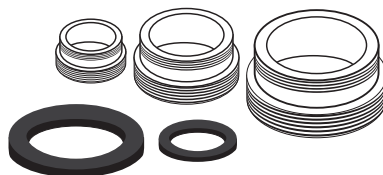

Assortment of Connectors
and Rubber Washers

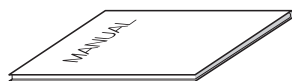

1 User Manual



1 pH Testing
Solution Bottle

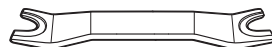

Wrench

Tools You Will Need



Utility Scissors

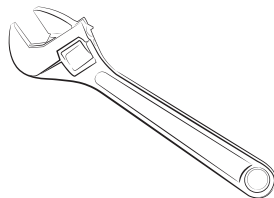

Adjustable Wrench

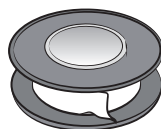

Plumber's Tape

Unit Overview

Make sure you are familiar with the parts and features of this unit, and carefully read the user manual and other important information

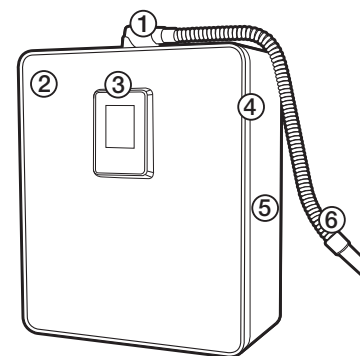

Front View

1. Water Outlet Unit
2. Front Cover
3. LCD Display
4. Front Case
5. Middle Case
6. Water Outlet Tube

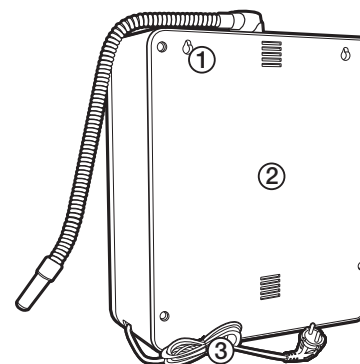

Rear View

1. Hanging Groove
2. Rear Case
3. Power Cord

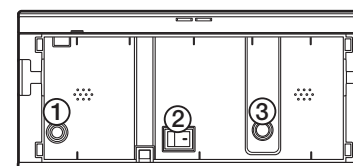

Bottom View

1. Water Inflow
2. Power Switch
3. Water Outflow

How to Install the Unit

Determine whether you will connect the unit directly to the cold water supply line (under sink) or to the faucet (see image).

- **Option A | Faucet:** A faucet connection requires a faucet diverter (included).
- **Option B | Under-Sink:** An under sink connection requires an under-sink adapter kit (not included) or a compatible t-valve (available from most hardware stores). For more information see Welcome Guide or call support.

Option A – Faucet Installation

Many faucets vary in design, and your faucet may require different setup instructions than those featured in this manual. Please consult a qualified service professional if you are unable to correctly complete the installation. For more help with installation, please visit tyentusa.com/support.

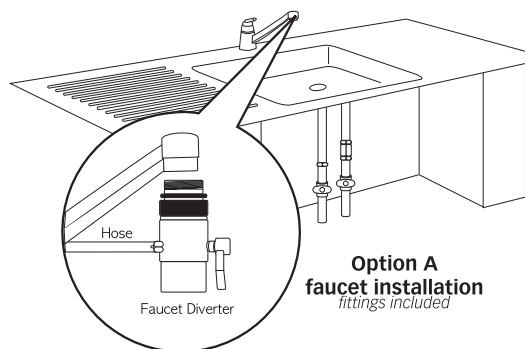

1. Shut off both the hot and cold water main supply at the pipe under the sink.
2. If your faucet features a screw-on style aerator, remove it by unscrewing it from the tip of the faucet.
3. If the included faucet diverter does not fit directly to the tip of the faucet, select an appropriate size connector and rubber washer (included).
4. When connecting the diverter or adapter to the faucet, be sure to use plumbing pipe thread seal tape (not included) to prevent leaks.
5. If necessary, connect the faucet diverter with the appropriate connector to the faucet.
6. Be sure all connections are secure but do not overtighten them.

Option B – Under-Sink Installation

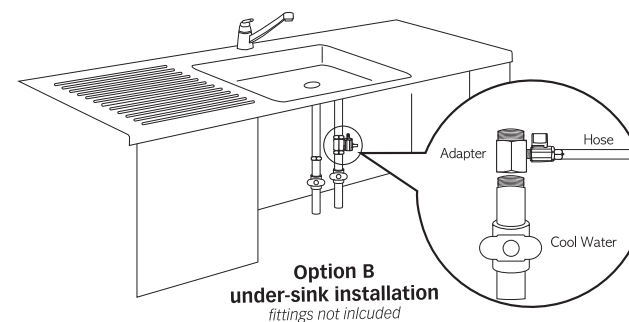

1. Purchase either an under-sink installation kit (not included) or purchase a T-connection (with shut-off valve) from a hardware or plumbing supply store.
2. Shutoff both the hot and cold water main supply at the pipe under the sink.
3. Locate the cold water supply line valve.
4. Disconnect the faucet cold water supply line from main cold water pipe. Use a towel to catch the small amount of water that may come from the faucet supply line.
5. When connecting the T-connection to cold water pipe, be sure to use plumbing pipe thread seal tape (not included) to prevent leaks.
6. Reconnect the faucet cold water supply line to the T-connection (now secured to the main cold water pipe).
7. Be sure all connections are secure but do not overtighten them.

Both Options

Do not turn on the main water supply until all hoses are properly installed to the unit. The unit and components are subject to change without prior notification in order to enhance performance.

Water Hose Installation

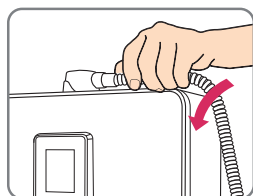

1. Place the unit on the planned installation location and screw the flexible tube clockwise into the water outlet hole positioned at the top of the unit. Do not overtighten.

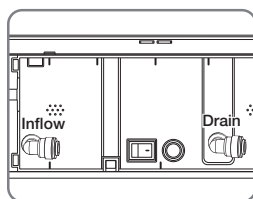

2. Press the stem elbows into the water inflow and outflow holes located on the bottom of the unit until you hear a click and feel the hose sit firmly in place.

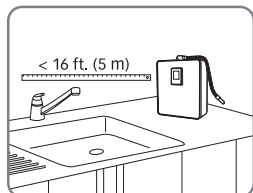

3. Measure between where the unit will be located (on the counter) and the water faucet (or under-sink T-connection) where the diverter (or T-connection) will be installed. Cut enough hose to allow connection from the rear of the unit to the water supply (either faucet diverter or under-sink T-connection).

Note: Keep the length under 16 feet (5 meters) from the unit to the faucet. You may need a pressure pump or larger size hose if the pressure is too low. Be sure to leave a few extra inches (centimeters) of length so the faucet can still be rotated.

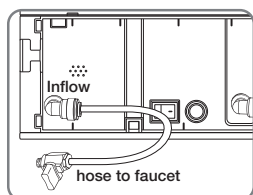

4. Connect the hose from the inflow hole to the cold water supply, either at the faucet diverter (Option A - Remove the nut from the diverter, slide the nut on to the hose, firmly seat the hose on the faucet diverter and screw the nut over the hose and back onto the faucet diverter) or the under-sink T-connection. (Option B - Route the hose through the counter top to the T-connection, firmly seat the hose on the T-connection, make sure the connection is sealed completely)

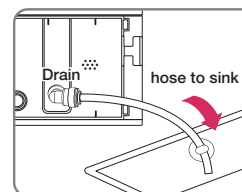

5. Cut an appropriate length of drain hose and connect it to the drain on the rear of the unit. Make sure the drain hose is positioned lower than the unit and in the sink to drain properly.

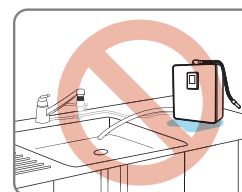

6. Make sure all hose connections are firmly seated in the correct holes, both on the unit and at the water supply.

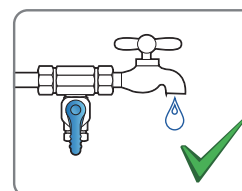

7. Turn on the cold water supply. Make sure there are no leaks at any of the connections. Make sure the faucet is working with the cold water. Make sure there are no leaks from the hose connections on the bottom of the unit. Make sure the hoses are firmly seated in the unit holes.

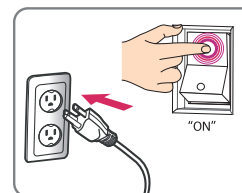

8. Plug in the power cord and turn on the unit. You should hear a series of tones when you power up the unit.



※ INTRO screen appears in about 1 minute only when initial power is supplied.

Customer Serviceable Parts

ATTENTION: The consumer accepts any and all responsibility and/or liability if replacement filters and/or purchased parts are not manufacturer specific. This unit contains high-performance purifying filters and an advanced control system.



Primary Filter: **ACE YT20 1st Filter**

Recommended filter replacement cycle:

951.0 gallons (3,600 L) / Every 6 months

Removes harmful chemicals like chlorine, compounds such as agrichemicals and detergents, large suspended matters like rust and sediments as well as other volatile organic compounds through an efficient, an activated absorption method. It also eliminates bad smells and any remaining dissolved chlorine.



Secondary Filter: **ACE YT20 2nd Filter**

Recommended filter replacement cycle:

951.0 gallons (3,600 L) / Every 6 months

0.01 micrometer filter helps eliminate contaminated materials including bacteria, while maintaining minerals in the water.

The life of the filter can vary greatly due to use, water pressure, water quality and the changing of the seasons. Filters may need to be replaced sooner than the scheduled time due to these reasons, you may notice reduced water quality or declining water taste.

How to Change the Filters

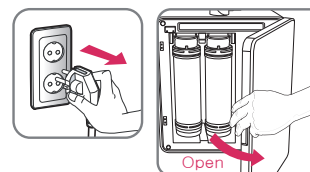

1. Shut off the water supply to the unit. Turn the power off and unplug the power cord. Open the door in front of the product.

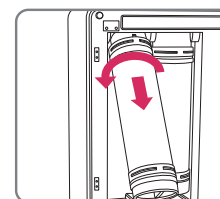

2. Raise the filter to be replaced and turn it counter clockwise to remove it.

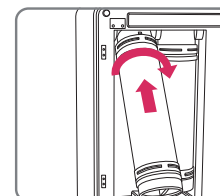

3. Put the new filter into the right position by turning it clockwise.

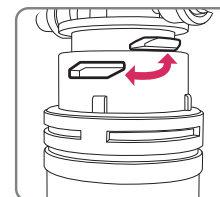

4. When installing the filter, the connection bump of the head and the connection groove on the top of the filter should be completely combined.

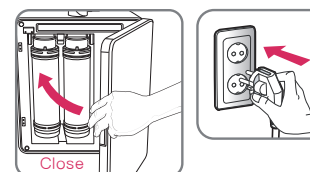

5. Close the door, plug the power cord back in, reengage the water supply and switch the unit back on.

How to Reset the Filters

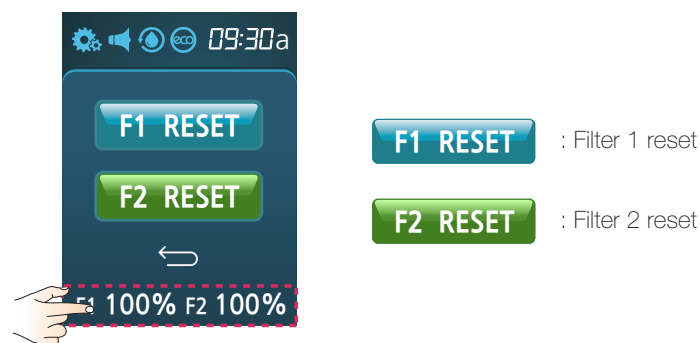

1. First Filter Reset

- ① Press the bottom part of the LCD screen.
A menu will appear on the LCD screen.
- ② To initialize, press the F1 RESET icon 2 times.
※LCD: Percentage (%) of initialization of filter

2. Second Filter Reset

- ① Press the bottom part of the LCD screen.
A menu will appear on the LCD screen.
- ② To initialize, press the F2 RESET icon 2 times.
※LCD: Percentage (%) of initialization of filter

Press the "←" "RETURN" bottom when returning to the home screen

CAUTION! Use the filter initialization icon only after the filter is changed.

Operation of the Touch Screen

1 Standby mode



Home screen

	Set up	ALK	Alkaline water
	Voice on	ACD	Acidic water
	Voice off	H2O	Purified water
	Cleaning	TURBO	Turbo water
	Eco mode on	F1	Filter 1 usage
	Eco mode off	F2	Filter 2 usage

- ① Display line of the set status
- ② Functional water operation
- ③ Display line of filter usage (Default : 00%)

Alkaline screen

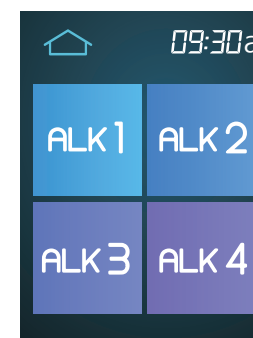

ALK1	Alkaline level 1
ALK2	Alkaline level 2
ALK3	Alkaline level 3
ALK4	Alkaline level 4

Acidic screen



ACD1	Acidic level 1
ACD2	Acidic level 2
ACD3	Acidic level 3
	Home button

2 Menu window



Push the upper part of the LCD screen.
The menu window will appear on the LCD screen.

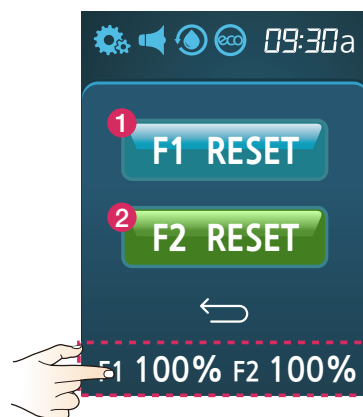

-  1 Setup (page 31)
-  2 Voice on/off (page 36)
-  3 Cleaning (page 37)
-  4 Eco mode on/off (page 38)

Push the upper part of the LCD screen.
The menu window will appear on the LCD screen.



-  1 Filter 1 reset
-  2 Filter 2 reset

CAUTION! Use the Filter Initialization Icon only after the filters have been changed.

3 LCD Display



Selected mode

Auto flow stop time indicator

Working indicator

DISPLAY CHANGES

LCD display will match the pH level color according to water pH level being used after icon is pressed.



4 Message Display

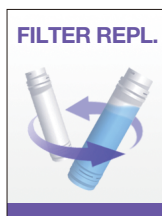

When this image is displayed, it is time to replace the filters (p. 21~22)



After you suspend the water supply to the unit, this message will appear before the water outflow stops.

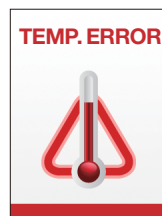

When this is displayed, water inside the unit is hotter than 95°F (35°C). The water supply will then be shut off and the unit will stop operating temporarily. (p. 42)

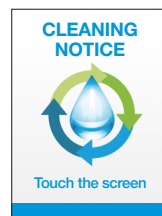

When the automatic cleaning time comes, this warning will be displayed.

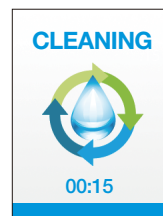

When this image is displayed, the unit is being cleaned, which can be done automatically and/or manually.

CAUTIONS in using the touch screen

1. It may be difficult to see the screen in direct sunlight.
2. Do not use sharp or pointy objects to press the screen.

When using the Touch Screen

1 Alkaline water outflow



- 1 Press the "ALK" icon on the Home screen.



- 2 Press the desired water level icon on the alkaline screen.



- 3 The water outflow starts. The screen will display the current level and stop time. Press the screen to stop the flow of water.



- 4 When done, the screen will return to the alkali screen.



Press the Home button to return to the home screen.

2 Acidic water outflow



- 1 Press the ACD icon on the Home screen.



- 2 Press the desired water level icon on the acidic screen.



- 3 The water outflow starts. The screen will display the current level and stop time. Press the screen to stop the flow of water.



- 4 When done, the screen will return to the acidic screen.



Press the Home button to return to the home screen.

3 Purified water outflow

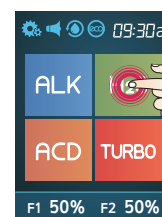

- 1 Press the H₂O icon on the Home screen.

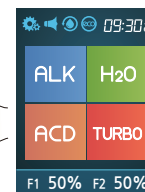

- 2 The water outflow starts. The screen will display the current level and stop time. Press the screen to stop the flow of water.
- 3 When done, screen moves to Home screen.

4 Turbo function outflow



- 1 Press the Turbo icon on the Home screen.

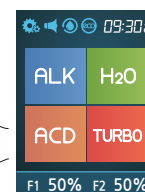
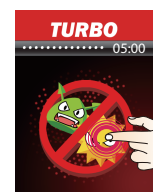

- 2 The water outflow starts. The screen will display the current level and stop time. Press the screen to stop the flow of water.
- 3 When done, the screen will return to the standby mode screen



Press the Home button to return to the home screen.

pH Level Adjustment

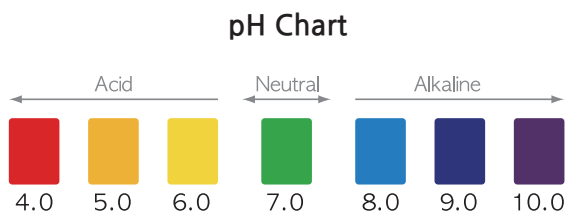

When testing the pH, be sure to allow the unit to run for 2 minutes before taking a sample of the water. If you have to adjust the percentage, after adjusting, run an additional 2 minutes before taking a sample. When testing pH values, we like to use 2 tablespoons of the water being produced and 4 drops of the reagent in a clear glass.

The minimum and maximum Turbo waters produced will depend on the water source quality. Set Turbo at 99% for maximum pH levels. These levels can range normally as follows:

Color of pH testing of each level:

Alkaline Turbo (dark purple)
 Acid Turbo (red)
 Alkaline Level 1 Approx. 8.0-8.5 pH (light blue)
 Alkaline Level 2 Approx. 8.5-9.0 pH (dark blue)
 Alkaline Level 3 Approx. 9.0-9.5 pH (light purple)
 Alkaline Level 4 Approx. 9.5-10.0 pH (med purple)
 H₂O = Approx. 7.0 pH (green) Purified Water
 Acid Level 1 Approx. 5.5 pH (light yellow)
 Acid Level 2 Approx. 4.5 pH (light orange)
 Acid Level 3 Approx. 3.5 pH (red)

*pH value indicated for each level is based on standardized test result which have used average tap water.

System Setup Method

1 ALKALI pH Level Adjustment



- 1 Press the top left corner of the screen. The menu options will fall below the upper part of the screen.
- 2 Press the setup icon.



- 3 Press **ALKALI pH**.

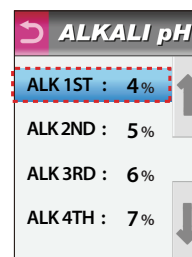

- 4 Press the desired level.

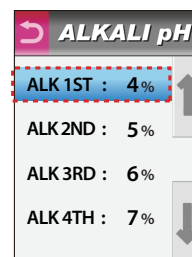

- 5 : ALK pH level up (9%, 10%, 11%...)
 : ALK pH level down (7%, 6%, 5%...)

If you push the UP/DOWN icon, the digital number will increase or decrease by one level.

Push the RETURN icon for the previous menu screen. Voice says : "Applied"
 Push the RETURN icon again to complete setup.
 Voice says : "Setup was completed"

2 ACIDIC pH Level Adjustment

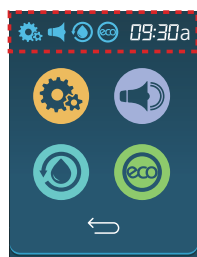

1 Press the top left corner of the screen. The menu options will fall below the upper part of the screen.

2 Press the setup icon.



3 Press **ACIDIC pH**.

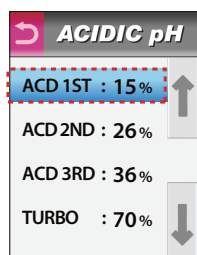

4 Press the desired level.

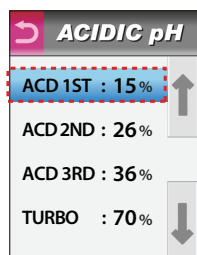

5 : ACD pH level up (8%, 9%, 10%...)

: ACD pH level down (6%, 5%, 4%...)

If you push the UP/DOWN icon, the digital number will increase or decrease by one level.

Push the RETURN icon for the previous menu screen. Voice says: "Applied"
Push the RETURN icon again to complete setup. Voice says: "Setup was completed"

3 LANGUAGE Mode



1 Press the top left corner of the screen. The menu options will fall below the upper part of the screen.

2 Press the setup icon.



3 Press **LANGUAGE**.



4 Press the desired language.

Supported language

KOREAN, ENGLISH, CHINESE, SPANISH

If you push the UP/DOWN icon, the digital number will increase or decrease by one level.

Push the RETURN icon for the previous menu screen. Voice says: "Applied"
Push the RETURN icon again to complete setup. Voice says: "Set up was completed"

4 VOLUME Level Adjustment

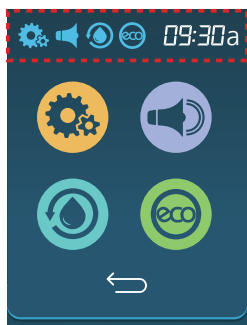

1 Press the top left corner of the screen. The menu options will fall below the upper part of the screen.

2 Press the setup icon.



3 Press **VOLUME**.



- 4 : Volume up (0 - 10) (delete step)
 : Volume down (0 - 10) (delete step)
 Pressing this icon will let you hear the current volume.

If you push the UP/DOWN icon, the digital number will increase or decrease by one level.

Push the RETURN icon for the previous menu screen. Voice says : "Applied"
 Push the RETURN icon again to complete setup.
 Voice says : "Setup was completed"

5 Setting the TIME

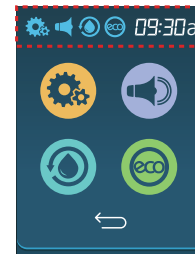

1 Press the top left corner of the screen. The menu options will fall below the upper part of the screen.

2 Press the setup icon.



3 Press **TIME**.



- 4 Adjust the time and date with the arrows :
 a Year b Month
 c Day d Hour
 e Minute



- 5 : for up : for down

Time setup is complete.

If UP/DOWN Icon is pushed, digital number moves by one step.

Push RETURN icon for previous menu screen. Voice says : "Applied"
 Push RETURN icon again to complete set up.
 Voice says : "Set up was completed"

Selecting Voice ON/OFF



- 1 Press the top left corner of the screen. The menu options will fall below the upper part of the screen.

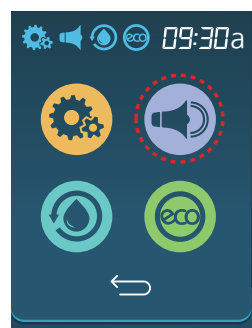

- 2 Select the **VOICE** icon.



※ Even if the volume is turned off, warning notifications will still play through the speaker if necessary. (filter replacement, water not supplied, TEMP, cleaning, setup mode).

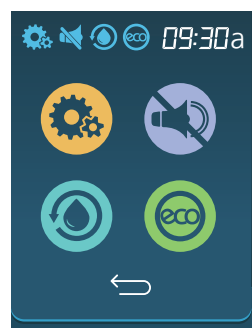

- 3 The voice will be turned on/off by selecting the voice icon in this sequence.



Cleaning Function

Cleaning can take place automatically and/or manually.

- Auto Cleaning (15 seconds) is performed during water outflow after more than 24 hours of non-operating or after 30 liters of water outflow.
- Manual Cleaning (15 seconds) is performed whenever desired simply by touching the  icon.

Auto Cleaning

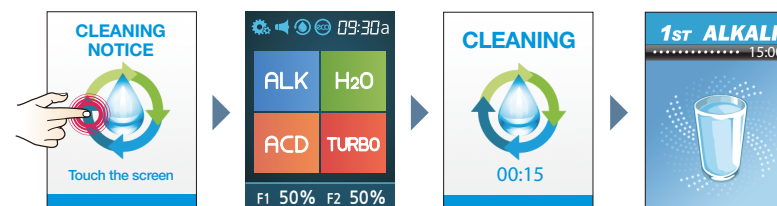

- 1 If the screen is touched, it changes to the previous used screen.
- 2 When functional water is selected on Standby mode, it goes into automatic cleaning for 15 seconds, and the selected functional water will be dispensed.

Manual Cleaning

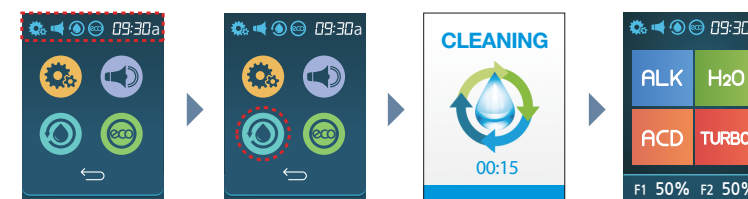

- 1 Press the top left corner of the screen. The menu options will fall below the upper part of the screen.
- 2 Press the **CLEANING** icon.
- 3 Cleaning mode stops after 15 seconds and the screen changes to the home screen.

ECO Mode

ECO Mode is a feature to indicate the time on the display during periods of nonuse.



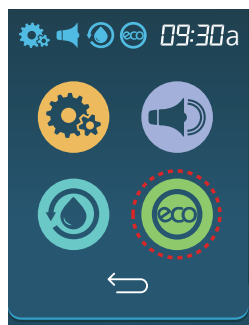

- 1 Press the top left corner of the screen. The menu options will fall below the upper part of the screen.

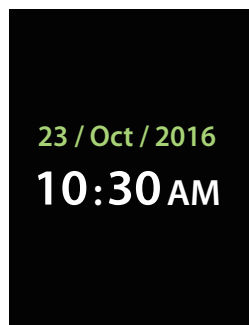

- 2 Select the **ECO** icon. 



- 3 Turn on/off ECO Mode by selecting the ECO icon in this sequence.   

When ECO Mode is set, the unit consumes less power during periods of nonuse. The screen will display the time if ECO Mode is set 10 minutes after using the unit. If the screen is touched, it changes to standby mode by displaying the last screen used.

TURBO Function

The TURBO function allows you to create strong alkaline and acidic water. These types of water are **ONLY** to be used for cleaning, sanitizing and disinfecting purposes.



pH 2.5
~ pH 3.8



Used to disinfect
and sterilize



pH 10.0
~ pH 11.8



To remove stains from
fabrics/carpet/upholstery

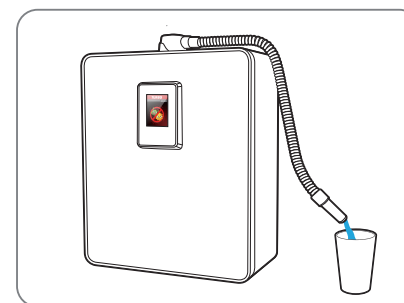

Alkaline Turbo Water Outflow

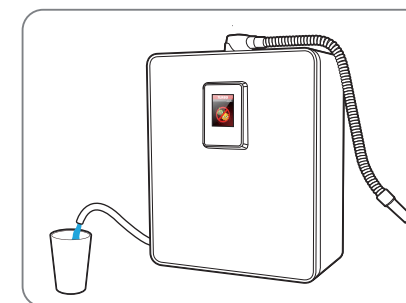

Acidic Turbo Water Outflow

Caution



The waters produced in **TURBO** mode are not intended for drinking.
DO NOT DRINK these types of waters.
DO NOT Use the **TURBO** function in a manner other than directed.

Usage Recommendations

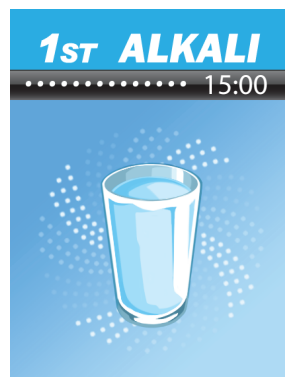

1st Alkaline Water
(Drinking Level 1)

Suitable for initial stage of drinking



2nd Alkaline Water
(Drinking Level 2)

Suitable for regular drinking



Clean Water

Creates purified water. For taking medications and making baby formula

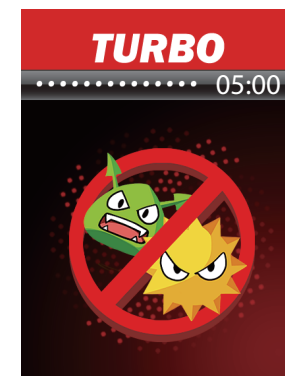

TURBO Function

DO NOT DRINK. Strong acid/alkaline water that must be used when cleaning, disinfecting, washing and sterilizing



3rd Alkaline Water
(Drinking Level 3)

For making coffee and tea and for watering plants



4th Alkaline Water
(Drinking Level 4)

Washing vegetables, dishes and making rice



1st Acidic Water
(DO NOT DRINK)

For washing hands and face



2nd Acidic Water
(DO NOT DRINK)

For washing vegetables and fruits



3rd Acidic Water
(DO NOT DRINK)

For washing dishes

Temperature Sensor

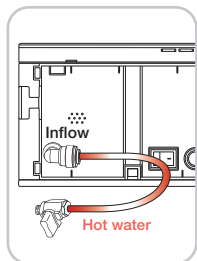

- Should water with a temperature higher than 95°F (35°C) get into the unit, the water supply will automatically be shut off and the unit will stop operating temporarily.

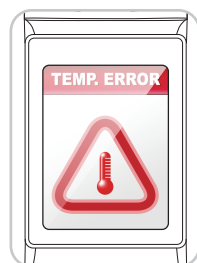

- LCD: **TEMP ERROR**

- Bring the source water temperature within the proper range.

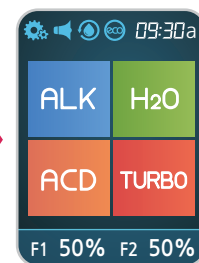
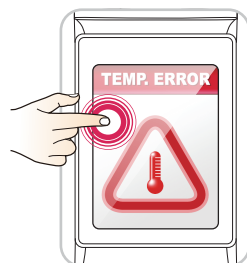

- If you press the error icon, the display will switch to the previous used screen.

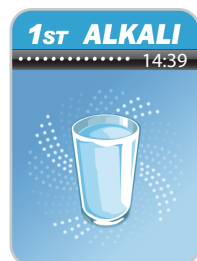

- When the source water is within the proper range, the ionizer will resume proper function and water will flow.

※To ensure the highest functionality, Tyent reserves the right to make changes to the system without notice.

Unit Specifications

Model Number of ACE Series	YT20-TL13	YT20-TL11	YT20-TL9	YT20-TL7
Electrolytic Cell Quantity of Electrodes	13	11	9	7
Power Consumption	Max 220W	Max 220W	Max 220W	Max 220W
TURBO Function	○	○	○	○
Product Name	TYENT Water Ionizer			
Purifying Mode	DM filtration mode			
Rated Voltage	100 -130 V~ / 200 - 240 V~ , 50/60 Hz			
Available Temperature	39°-95° F (4°-35° C)			
Operating Pressure Range	0.1- 0.5 MPa			
pH Levels	4 alkaline, 1 neutral, 3 acidic , turbo			
Adjustable pH	User- adjustable pH level control			
Filters Configuration	2-filter system			
Filter Life Display	LCD filter replacement and announcement			
Water Cell Plate Materials	platinum and titanium			
Product Size	11.8 (W) x 5.3 (D) x 13.9 (H) inches			
Product Weight	10.8 lbs			

※To make the best functionality, there may be some change without notices.

Troubleshooting

Symptoms	Checkpoints	Measures to be Taken
Abnormal Taste	Check period of use.	Run the unit for one minute, draining stagnant water.
	Check the last time the filter was replaced.	Replace the filter.
Water Outflow Change	Check whether the valve on the water supply is closed.	Open the Valve.
	Check whether the hose is bent or folded.	Stretch out the hose.
	Check whether the flow rates are low. (less than 1ℓ/ min.)	Contact us to install a water pump.
	Check whether the water supply is cut off or whether the water supply line is frozen.	Wait until water comes out of the water supply pipe.
Incorrect pH levels	Check whether the filter is clogged.	Change the filter.
	Check water for solidity.	Water quality varies by region.
	Check flow rates for higher levels.	Reduce the amount of raw water.
Filter replacement icon remains "on" even after filter has been replaced	Check whether the amount of drained water is small.	Contact us. Request after-sales service.
	Check whether the filter flow rate is initiated.	Initialize the water flow rate (system settings mode) or request service.
Unit stops during use.	Check whether the operating time exceeds 15 minutes. (*Turbo function: 5 minutes.)	Unit stops automatically after 15 minutes. (*Turbo function: 5 minutes.)
Unit leaks.	Check the filter for proper mounting.	Unplug unit. Contact us.
	Check other areas of the unit.	
Settlement in extracted water.	Check for excessive calcium in the source water.	Contact us for an additional filter.
Only purified water is extracted.	Check whether the flow rate is high. (5 kgf/cm or faster.)	Contact us to install a pressure-reducing valve.
The Unit doesn't operate in cleaning mode.	Check whether the operating time exceeds 24 hours.	The unit returns to normal after performing auto cleaning for 15 seconds.
	Check whether the cleaning icon is pressed.	
	Check whether the amount of working water exceeds 30 L.	
The screen turns off.	Check whether the nonoperating time exceeds 10 minutes.	If the unit is not used the unit for 10 minutes, it changes to the ECO mode automatically. The unit returns to normal after touching the screen

Product Warranty

1. This product features a lifetime warranty. If any manufacturing defects or spontaneous failures occur during the warranty period, the unit will be repaired or replaced at no charge.
2. If any failure occurs, please call the service center. Note: The answers to many service questions can be found online at **tyentusa.com/support**.
3. In case of a failure resulting from the customer's negligence or intentional damage of the product, the customer shall be responsible for repair or replacement costs.
4. This warranty is non-transferable and valid only for the original owner.

Product Name	Model Number	Warranty Period
Tyent Water Ionizer	ACE-YT20-TL	Lifetime (above conditions apply)

Customer's Name/Phone	Date of Purchase
Customer's Address	Installation Date/Name



Tyent USA, LLC
www.tyentusa.com



137 Hurffville Crosskeys Rd, Sewell, NJ 08080
Toll Free: 855-TYENT-US